



Series 5061-2200

The Type 5061-2200 is a very low profile control head for applications where space is limited. It can also be used as a back up control head.

FEATURES

- Custom scales available
- Very low profile
- 96 mm x 96 mm size
- Dual sealed dial position sensors
- One or three detents standard
- Protection rating IP66 above console
- Meets or exceeds marine classification and regulatory requirements for Electromagnetic Compatibility, Vibration, Temperature and Humidity

APPLICATIONS

- Slide out wing stations with very limited height
- Back up for electronic control systems

DIAL CONTROL HEAD

TYPE DLH COMPACT AHD, AST & RPM CONTROL

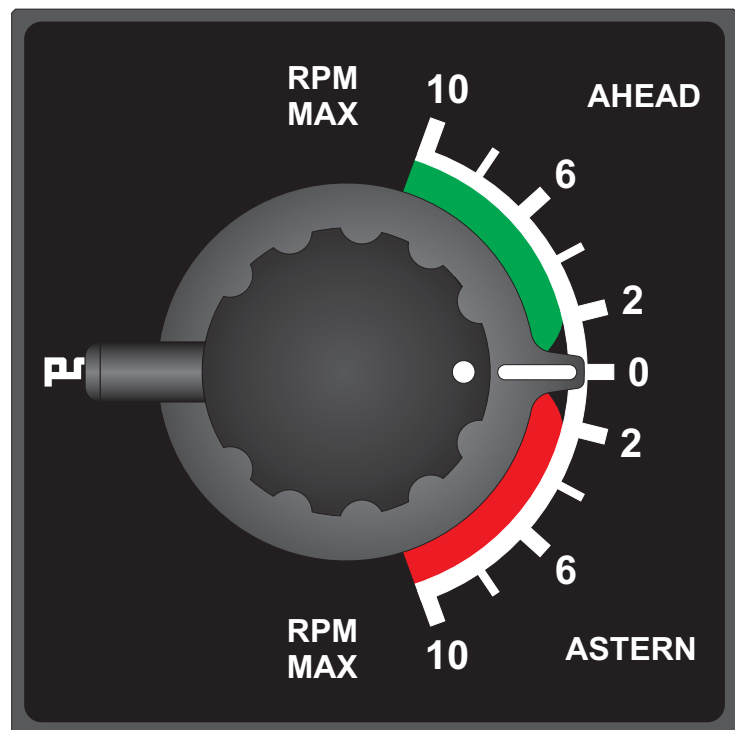

SCALE 1:1
RIGHT FACING MODEL SHOWN

DIMENSIONS FOR SERIES 5061-2200 DLH DIAL CONTROL HEAD

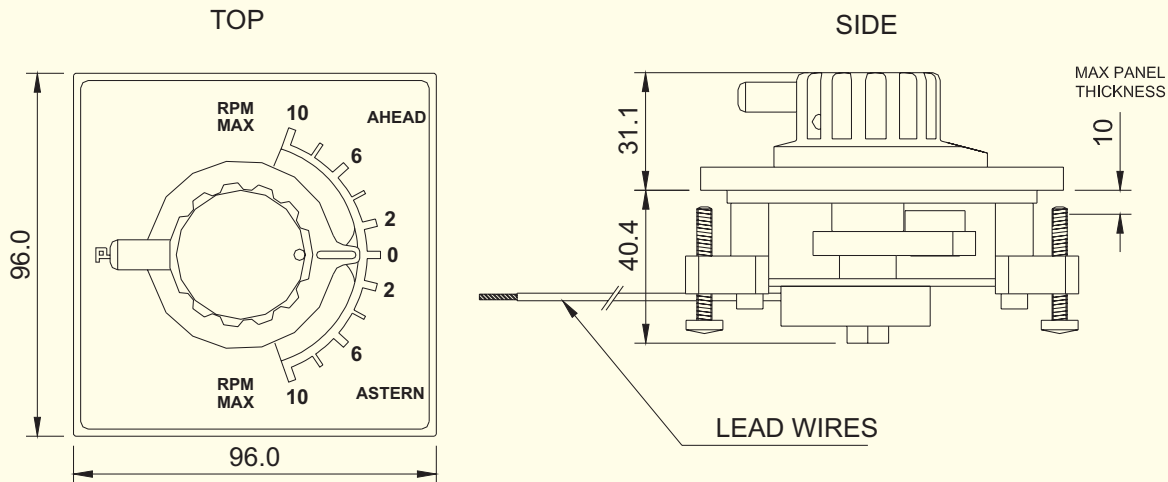

SCALE 1 : 2

SPECIFICATIONS:

Electrical:

- Dual 2.5 kΩ dial position sensors

Environmental:

- Sealed lever dial position sensor
- Operating temperature -40 to +120°C
- Storage temperature -40 to +120°C
- Vibration: Frequency range 2 to 100 Hz
Peak to peak amplitude 2 mm below 13.2 Hz
Acceleration amplitude 0.7 g above 13.2 Hz
- CE compliant for EMC (IEC/EN60945)

Physical:

- Ahd 70° to 0° to Ast 70° dial rotation
- P66 above console
- Dimensions:
96 mm L × 96 mm W × 71.5 mm H
(3.78" L × 3.78" W × 2.82" H)
- Weight, typical 500 g (1.3 lbs)
- 300 mm (12") lead wires 20 AWG SAE J-1560
Type TXL Stranded

TYPICAL ELECTRICAL CONNECTION

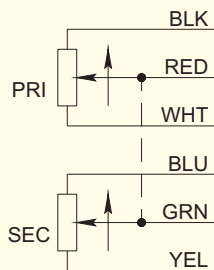

ARROW INDICATES DIAL
ROTATION IN THE AHEAD
DIRECTION

CUT OUT

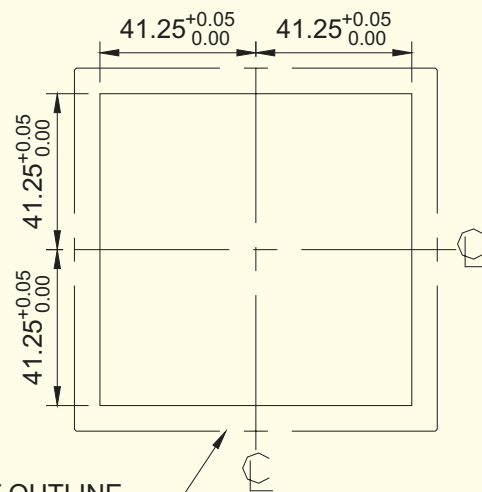

EQUIPMENT OUTLINE
96 X 96

PRIME MOVER CONTROLS INC.

3600 GILMORE WAY, BURNABY BC CANADA V5G 4R8