



# Type 8545-1150

The FTT-10A to RS422/485 gateway is a communication link between Lon Talk and RS 4 2 2 / 4 8 5 based communication protocols. In order to communicate safely electrical isolation is provided between the two communication ports.

### FEATURES

- ▶ Module power, FTT-10A and RS422/485 power supplies are electrically isolated
- ▶ RS422/485 receive and transmit lines, are optically isolated
- ▶ Transmission rates up to 115.2 kBd
- ▶ Removable terminal blocks
- ▶ TS35x7,5 rail mount

### APPLICATIONS

- ▶ PMC Type 8202 Telegraph system data logger
- ▶ PMC Type 8503 Digital Electric Shaft / Telegraph system to PLC gateway
- ▶ LonTalk to printer / terminal driver
- ▶ Lon Talk to ModBus gateway

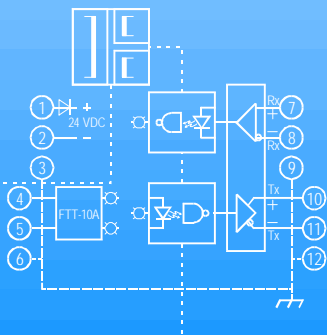

## FTT-10A TO RS485/422 GATEWAY

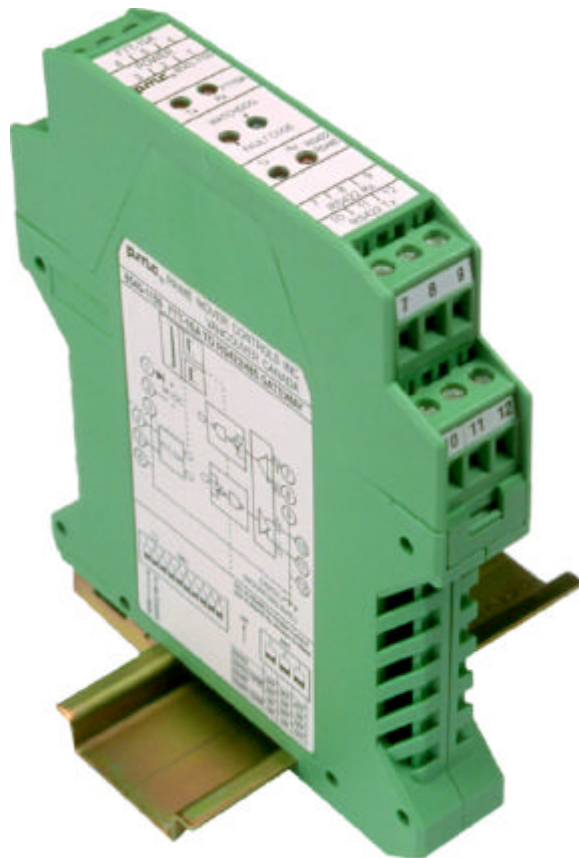

**PRIME MOVER CONTROLS INC.**

## DIMENSIONS FOR 8545-1150 GATEWAY

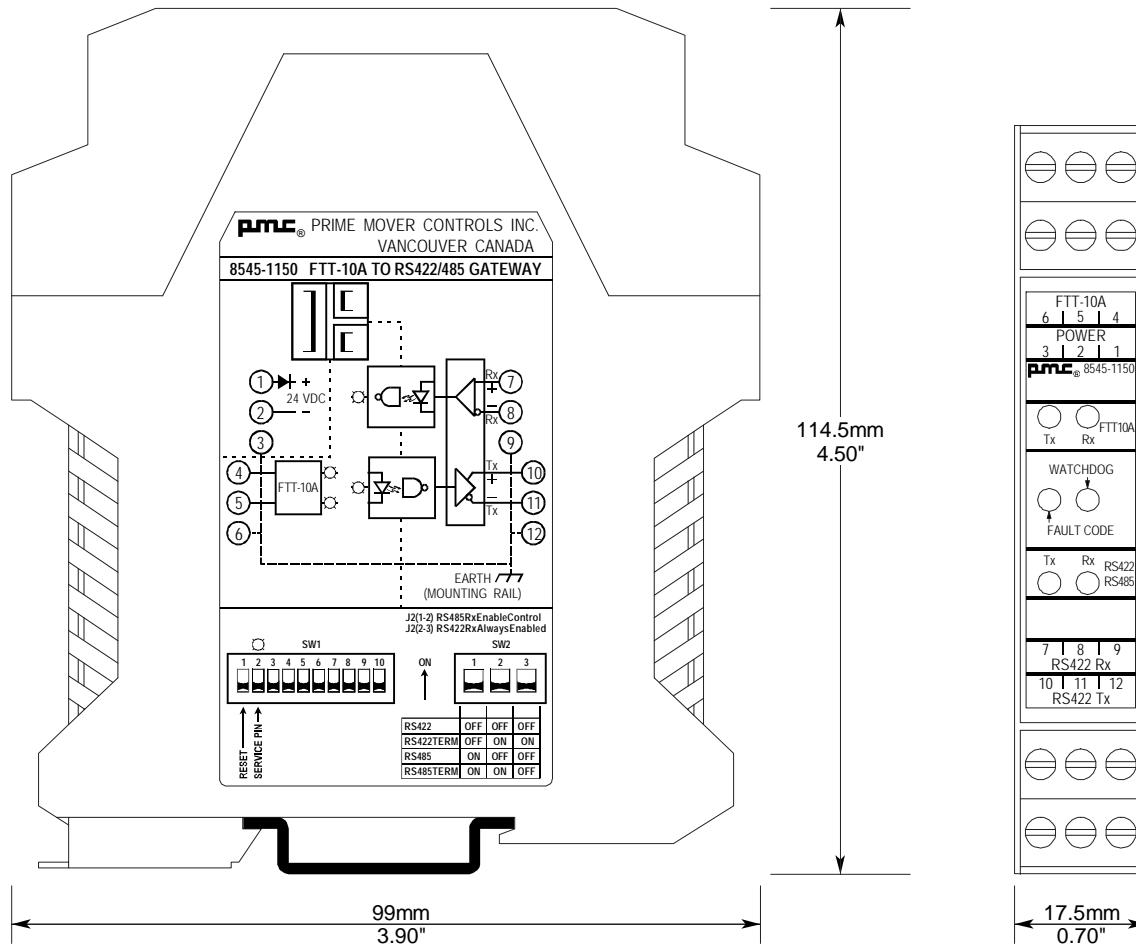

### SPECIFICATIONS:

#### Supply:

- ▶ Nominal 24 VDC, range 8 to 45 VDC
- ▶ 40 mA nominal, 100 mA max
- ▶ Reverse voltage protection

#### Environmental:

- ▶ Operating temperature 0 to +70°C
- ▶ Storage temperature -40 to +85°C
- ▶ Vibration: Frequency range 3-100 Hz  
Velocity amplitude 100 mm/sec below 22 Hz  
Acceleration amplitude 0.7 g above 22 Hz

#### Physical:

- ▶ IP30 Enclosure
- ▶ Dimensions:  
99mm L x 17.5mm W x 114.5mm H  
(3.90" L x 0.70" W x 4.50" H)
- ▶ Weight, typical 0.12 kg (0.27 lbs)
- ▶ Removable terminal blocks for 14 to 20 AWG wires

#### Connection:

- ▶ FTT-10A to RS422/485



## PRIME MOVER CONTROLS INC.

3600 GILMORE WAY, BURNABY B.C. CANADA V5G 4R8

TEL (604) 433-4644 FAX (604) 433-5570 www.dmc-controls.com